

Pos. Nr. Pos.no.	Beschreibung Description	Art.-Nr. Art.no.	Preisgruppe Price bracket
1	Flexplatine Flexible PCB	144762	11
2	TS - Fenster+Lichtnägel Part set - Windows+light pins	144764	11
3	Lichtnagel Light pin	144765	4
4	Rangiergriff Shunter hand-rail	144766	3
5	Umlaufrahmen Running way frame	144767	18
6	TS - Treppe+Bremseleitung Part set - steps+brake lines	144768	7
7	Tank Tank	144769	10
8	TS - Kasten, Behälter Part set - Boxes, container	144770	10
9	TS - Umlauf Part set - Running way	144771	7
10	TS - Scheibenwischer + Bremsschlauch Part set - Wipers+Brake tubes	144773	9
11	TS - Geländer Part set - Railing	144775	9
12	Platine Onboarddecoder PCB	144776	42
13	Motor KM Motor	145018	19
14	Motorvorbau Y.8202 Motor housing Y.8202	145020	30
15	Lautsprecher Loudspeaker	129524	14
16	TS - Gehäuse Part set - Body	145021	6
17	Führerhaus Drivers cab	145022	30
18	Spule Spool	144778	13
19	GF-Schraube M1 6x5 mm GF-Screw	115269	3

Änderungen in Konstruktion und Ausführung vorbehalten
We reserve the right to change the construction and specification

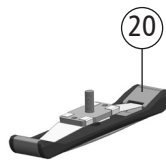
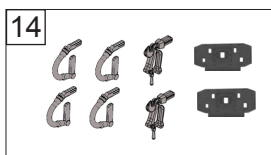
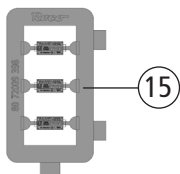
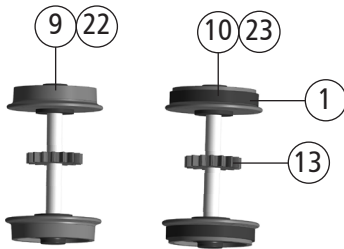
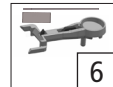
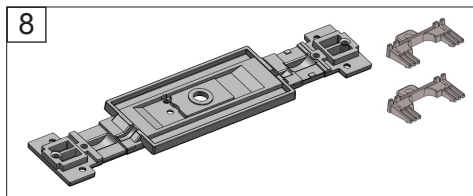
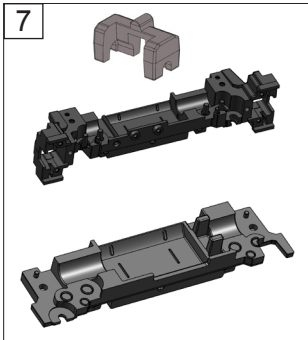
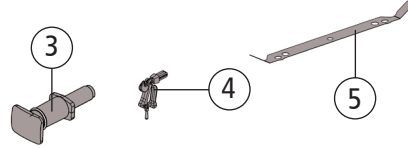
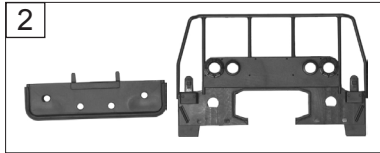

72009		SNCF		Y 8000		=		🔊	
78009						=		🔊	
Pos. Nr. Pos.no.	Beschreibung Description	Art.-Nr. Art.no.	Preisgruppe Price bracket						
1	Hafrings 10 stk. 10,3-12,8 Traction tyre	40069	---						
2	TS - Pufferplatte Part set Buffer plate	144763	14						
3	Puffer eckig Buffer rectangular	144772	3						
4	Zughaken kurz Coupling hook short	144774	3						
5	Radkontakt Wheel contact	144777	9						
6	TS - Digital Kupplung Part set - Digital coupling	143765	10						
7	Getriebesatz 3tlg. Gear set	144779	9						
8	Boden + Flexhalter Bottom + flexible holder	145017	7						
9	Radsatz m.Zahnrad o.Haftr. Wheelset w. gearwh. w/o traction tyre	145019	11						
10	Radsatz m.Zahnrad m. 1 Haftr. Wheelset w. gearwh. w. 1 traction tyre	145024	12						
11	Schneckenrad Z=10/15 M=0,4 Worm gear	86410	4						
12	Zwischenrad Z=12 M=0,4 Intermediate gear wheel	114163	3						
13	Zahnrad Gear wheel	86510	4						
14	Zurüstbeutel Bag of accessories	145023	9						
15	Tafelsatz Set of panels	145035	12						
16	GF - Schraube M1 6x4 mm GF - Screw	114850	3						
17	SK - Schraube M2x5 mm SK - Screw	115205	3						
18	SK - Schraube M1,6x3 mm SK - Screw	125023	3						
19	GF - Schraube M1,6x12 mm GF - Screw	115138	3						
AC - Wechselstrom									
20	Schleifer Slider	86030	14						
21	GF - Schraube M1 6x3 mm GF - Screw	143760	4						
22	Radsatz m.Zahnrad o.Haftr. AC Wheelset w. gearwh. w/o traction tyre	145025	11						
23	Radsatz m.Zahnrad m. 1 Haftr. AC Wheelset w. gearwh. w. 1 traction tyre	145026	12						